

No 14

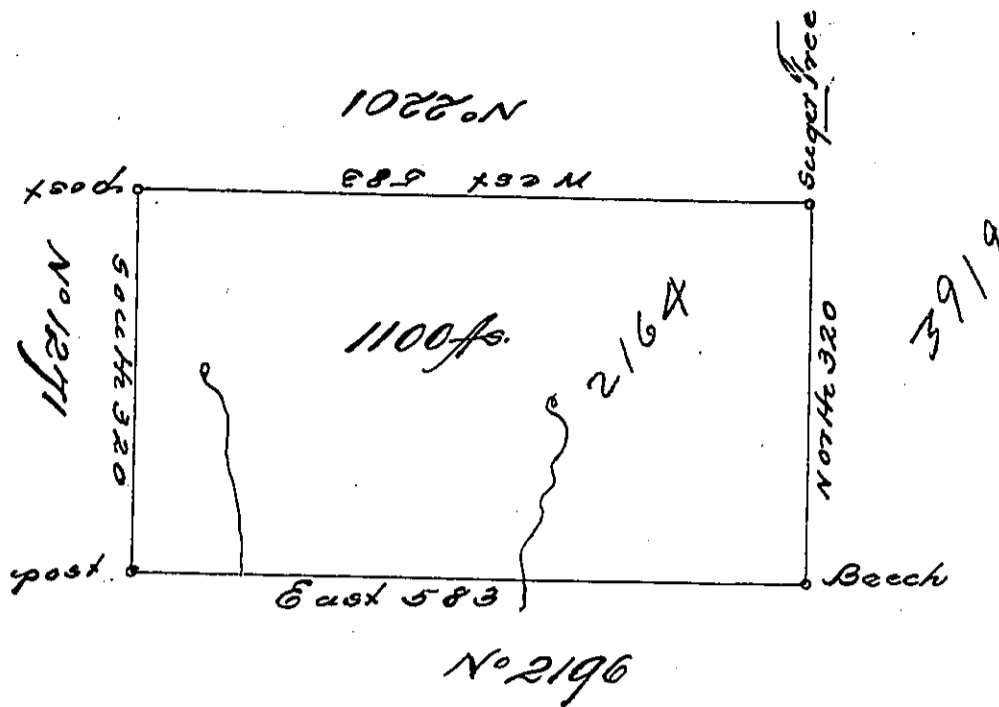

Situate about four miles South of the Allegheny River and two Miles East of the Portage Branch of Allegheny in North^d County containing 1100^{ac} and the usual allowance for Road W. Surveyed June 7th 1793 for Robert Gilmore in pursuance of a Warrant No 2164 bearing date the 12th day of December 1792.

Daniel Brodhead Esq.
D.Y.

John Canan D.S.

IN TESTIMONY that the above is a copy of the original remaining on file in the Department of Internal Affairs of Pennsylvania, made conformably to an Act of Assembly approved the 16th day of February, 1833, I have hereunto set my Hand and caused the Seal of said Department to be affixed at Harrisburg, this fourth day of October 1898

James W. Pitta
Secretary of Internal Affairs.